

SEG'SHOW 4 10X10

SEG'SHOW EXHIBITS

PRODUCT CODE: SEGSHOW4-10x10G



On frame On graphic



FRONT

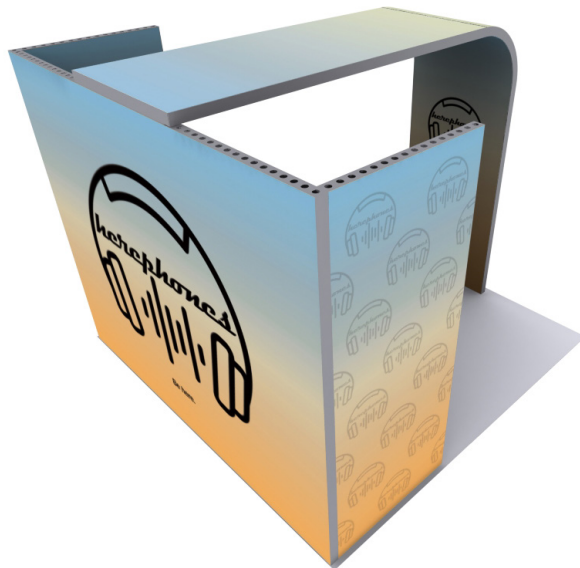

BACK

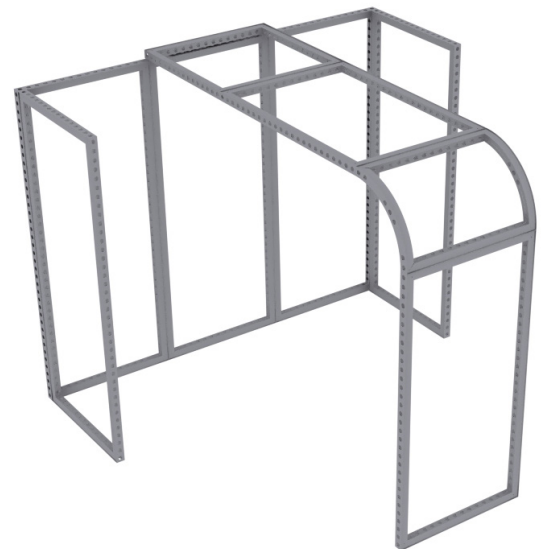
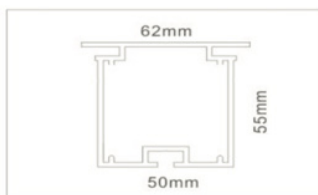
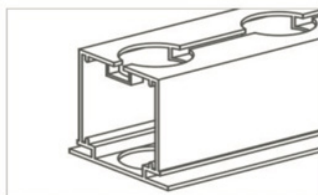

FRAME ONLY

PRODUCT DESCRIPTION

Seg'Show Modular Exhibits Modular 6 is a three-dimensional 10' x 10' pre-designed exhibit booth. Stylish and lively, Modco Modular Exhibits Modular 6 is built using tool-free perforated modular aluminum frames. Multiple size frames connect using simple toolless pin connectors. Customize double-sided stretch fabric SEG graphics for the entire exhibit.

DISPLAY DIMENSIONS	117.375"W x 97.9"H x 117.5"D		
GRAPHIC SIZES	PANEL	SIZE	QTY
	A	40.125"W x 96.25"H	4
	B	40.125"W x 109.125"	2
	C	40.125"W x 98.75"	2
	D	118.375"W x 96.25"H	2
TOTAL PRINTS			10

GRAPHIC MATERIAL

Dye Sub Fabric

GRAPHIC FINISHING

Silicone beading is sewn around the perimeter of the fabric graphic. Silicone beading is hidden from view once installed.

DISPLAY CONSTRUCTION

Aluminum frame and components

SHIPPING WEIGHTS & DIMENSIONS (FREIGHT ONLY)

Shipping Weight	lbs (frame & graphics in crate)
Shipping Dimensions	103"L x 44"W x 58"H (in crate)

GRAPHIC TURN AROUND TIME

5 business days after proof approval

AVAILABILITY	CA only
--------------	---------

PARTS LIST

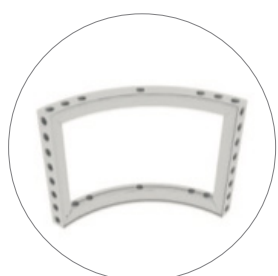

(qty 1)
MOD-CRVFRM-774x992

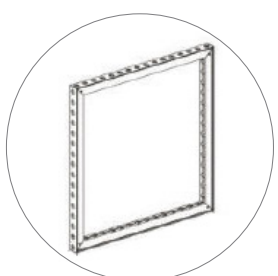

(qty 6)
MOD-FRM-992x2418

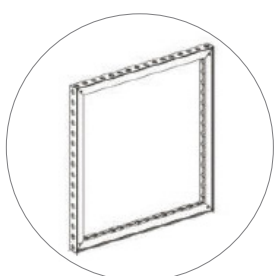

(qty 1)
MOD-FRM-992x1984

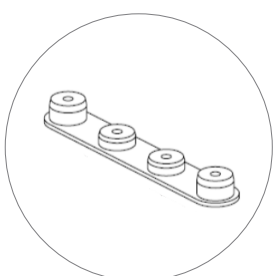

(qty 4)
MOD-180D-CON

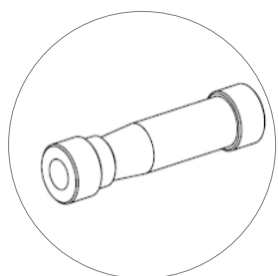

(qty 4)
MOD-CLA-CON

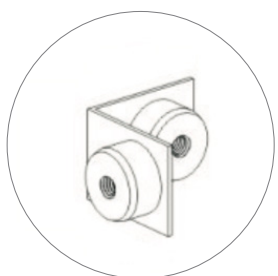

(qty 10)
MOD-90D-CON

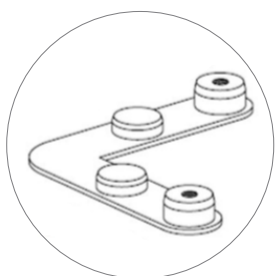

(qty 4)
MOD-SM90D-CON



(qty 2)
MOD-CP-3100

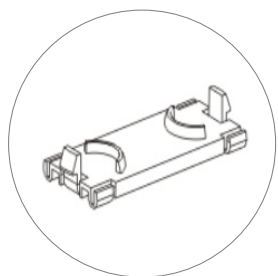

(qty 22)
MOD-CC



(qty 2)
MOD-CP-774



(qty 48)
MOD-PC



(qty 4)
MOD-SN28MM

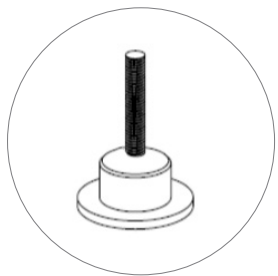

(qty 4)
MOD-PCWP-B

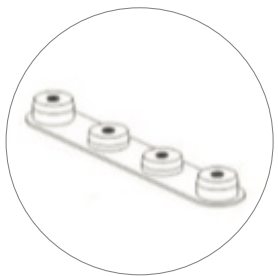

(qty 2)
MOD-CRV-180DCL

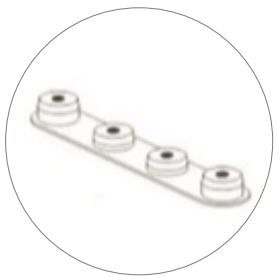

(qty 2)
MOD-CRV-180DCR

SET UP INSTRUCTIONS

MODCO 4-10x10

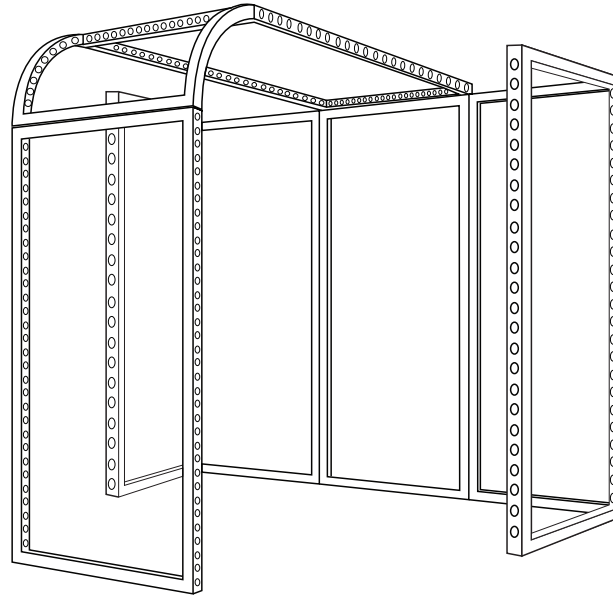

Instructions

Parts / Frames

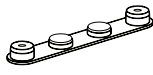

180° Connector
MOD-180D-CON
Qty.4

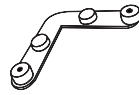

Small 90° Connector
MOD-SM90D-CON
Qty.4



Pin Connector
MOD-PC
Qty.48



Door Pin Connector
MOD-PCDOOR
Qty.4

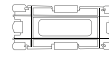

Clip Connector
MOD-CC
Qty.22

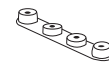

180° Curved Connector
MOD-CRV-180DCL Qty.2
MOD-CRV-180DCR Qty.2

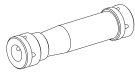

Clamp Connector
MOD-CLA-CON
Qty.4



90° Connector
MOD-90D-CON
Qty.10



1/4 Curved Cover Profile
MOD-CP-774
Qty.2



58° / 78° Cover Profile
MOD-CP-3100
Qty.2 - 58° / Qty.2 - 78°



95° Cover Profile
MOD-CP-3100
Qty.4



Pin Connector for Profile Cover
MOD-PCWP-B
Qty.4



28mm Screw Nut
MOD-SN28MM
Qty.4



992 x 1984
MOD-FRM-992x1984
Qty.1



992 x 2418
MOD-FRM-992x2418
Qty.6

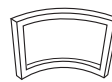

992 x 992
MOD-CRVFRM-774x992
Qty.1

Connections I

A

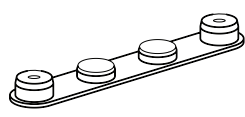

MOD-180D-CON / MOD-PC

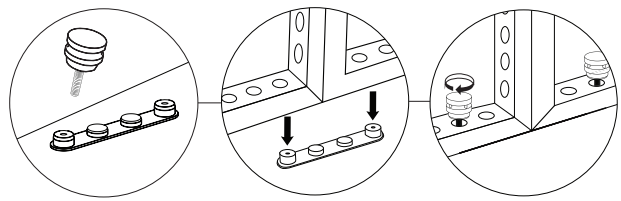

B

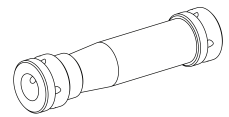

MOD-CLA-CON

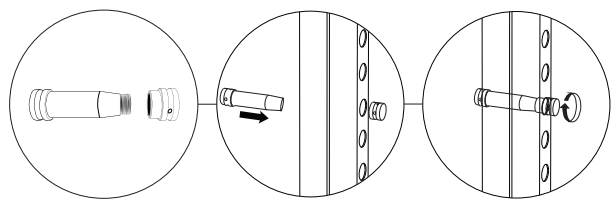

C

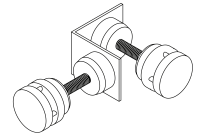

MOD-90D-CON + MOD-PC

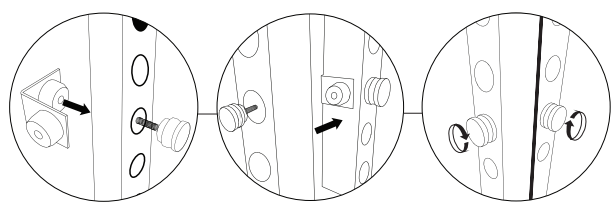

Connections II

D

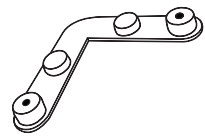

MOD-SM90D-CON / MOD-PC

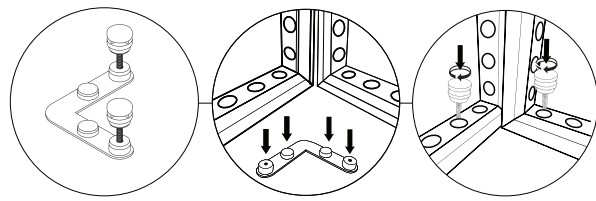

E

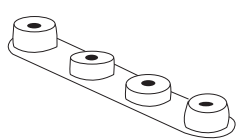

MOD-CRV-180DC / LEFT & RIGHT

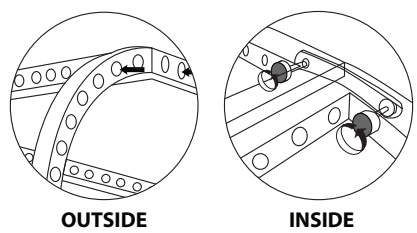

F

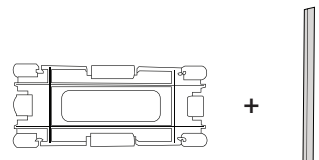

MOD-CC / MOD-CP-3100

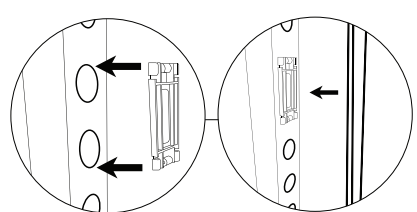

Connections III

G

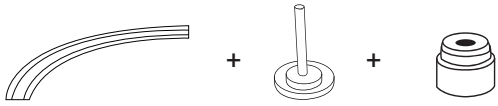

MOD-CP-774 MOD-PCWP-B MOD-SN28MM

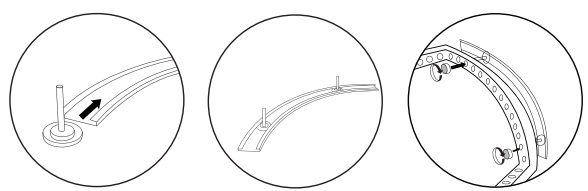

1

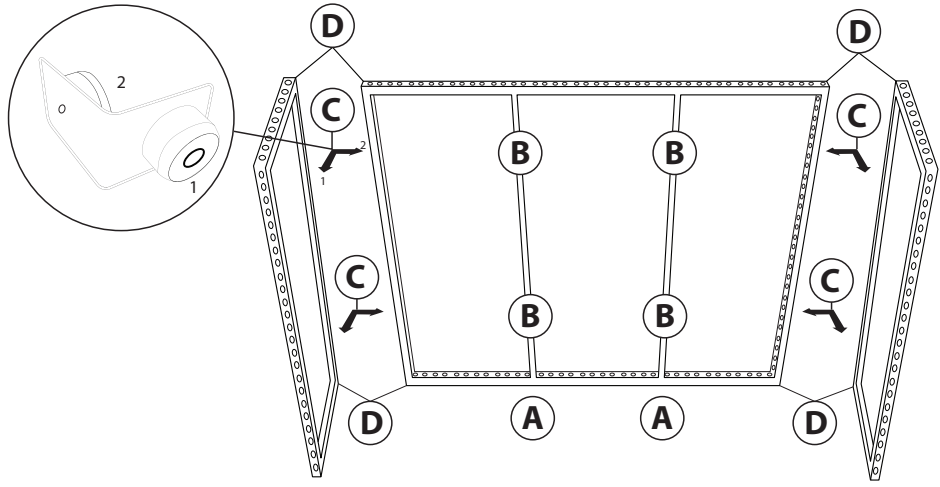

Attach (3) MOD-FRM-992x2418 in a row.
Next, attach (1) MOD-FRM-992x2418 to each adjacent side of the row - (2) sides total.
Reference the diagram above.

2

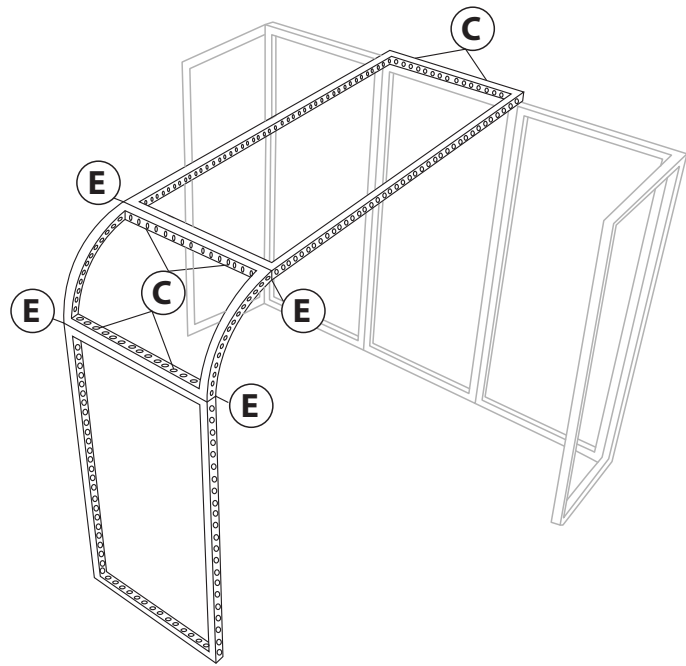

Cover Profiles

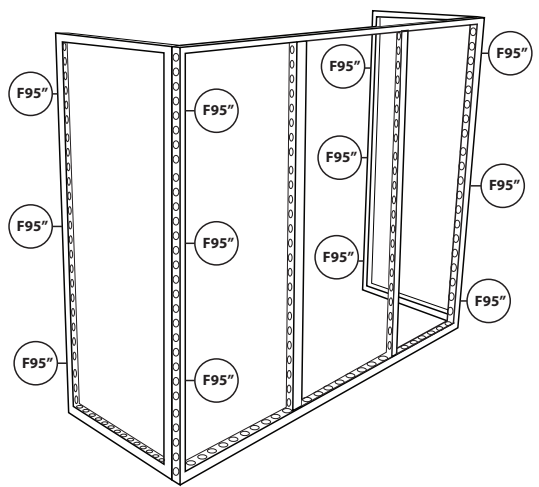
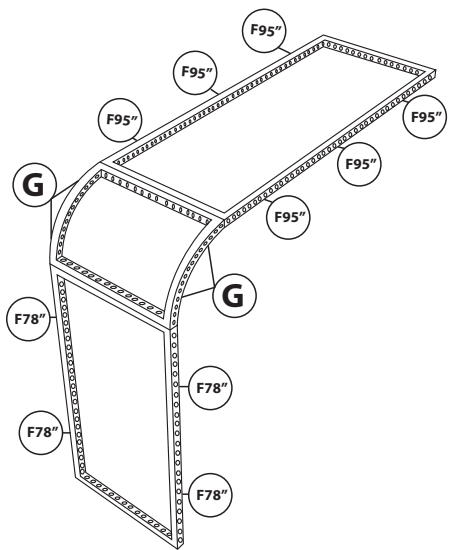

Snap in clip connectors at each designated point and then reference the measurement and install the cover profile.
*Overhead view - clip connectors/cover profiles to back side of configuration.

SEG'SHOW 4 10X10

SEG'SHOW MODULAR EXHIBITS
PRODUCT CODE: SEGSHOW4-10x10G



On frame On graphic

Graphic Install



Place graphic over the front of the frame.

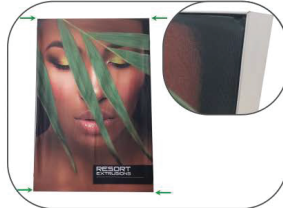

Begin inserting SEG beading at each corner.

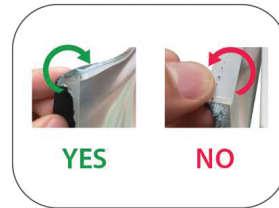

Insert the silicone beading with the fabric folded over. The silicone beading should not be exposed.

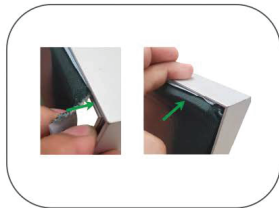

Using your fingers, push both fabric and silicone beading completely into the extrusions channel.

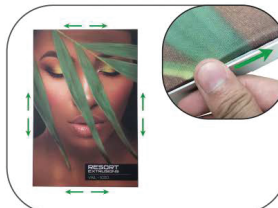

Continue to push in the remaining silicone beading on each side.



Check the perimeter of the frame for any excess beading that hasn't been pushed in. Graphic should be taut.