

SEG'SHOW 3-10X10

SEG'SHOW MODULAR EXHIBITS
PRODUCT CODE: SEGSHOW3-10x10G



On frame



On graphic







FRONT

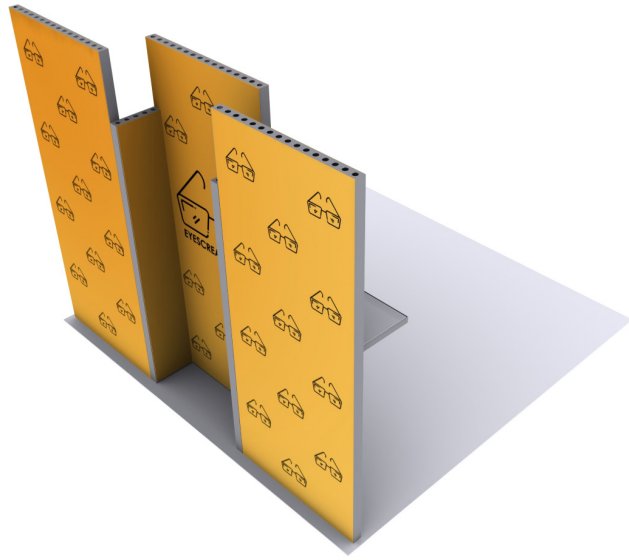

BACK

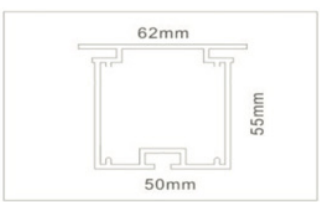
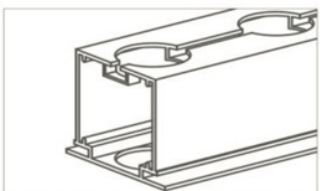

FRAME ONLY

PRODUCT DESCRIPTION

Seg'Show Modular Exhibits 3 - 10x10 is a three-dimensional 10' x 10' pre-designed exhibit booth. Stylish and lively, Modco Modular Exhibits Modular 5 is built using tool-free perforated modular aluminum frames. Multiple size frames connect using simple toolless pin connectors. Use shelves to showcase your products. Customize double-sided stretch fabric SEG graphics for the entire exhibit.

DISPLAY DIMENSIONS	117.375"W x 96.25"H x 17"D		
GRAPHIC SIZES	PANEL	SIZE	QTY
	A	13.125" W x 79.125"H	4
	B	40.125" W x 96.25"H	6
TOTAL PRINTS			10

GRAPHIC MATERIAL

Dye Sub Fabric

GRAPHIC FINISHING

Silicone beading is sewn around the perimeter of the fabric graphic. Silicone beading is hidden from view once installed.

DISPLAY CONSTRUCTION

Aluminum frame and components

SHIPPING WEIGHTS & DIMENSIONS (FREIGHT ONLY)

Shipping Weight	875 lbs (frame & graphics in crate)
Shipping Dimensions	103"L x 44"W x 58"H (in crate)

GRAPHIC TURN AROUND TIME

5 business days after proof approval

AVAILABILITY	CA only
--------------	---------

PARTS LIST

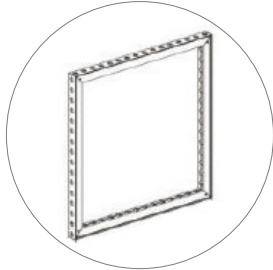

(qty 3)
MOD-FRM-992x2418

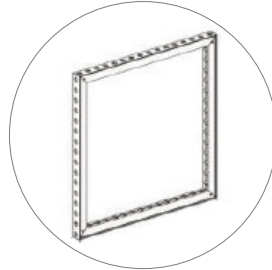

(qty 2)
MOD-FRM-310x1984

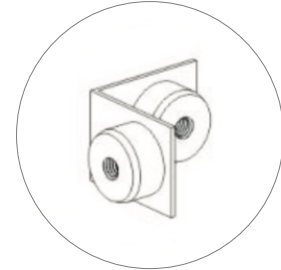

(qty 8)
MOD-90D-CON

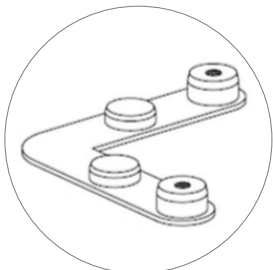

(qty 4)
MOD-SM90D-CON



(qty 5)
MOD-Cp-3100

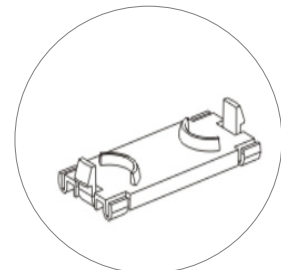

(qty 18)
MOD-CC

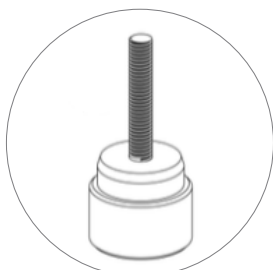

(qty 32)
MOD-PC

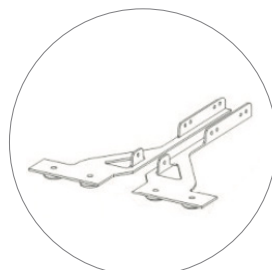

(qty 2)
MOD-SHELF-KIT-INS

SET UP INSTRUCTIONS

MODCO-5

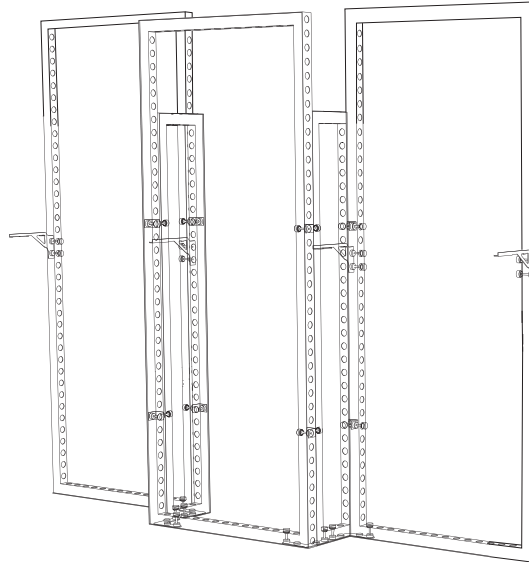

Instructions

Parts / Frames

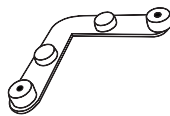

90° Connector
MOD-SM90D-CON
Qty.4



Pin Connector
MOD-PC
Qty.32



90° Connector
MOD-90D-CON
Qty.8

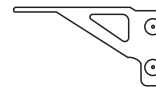

Shelf Holder
MOD-SHELF-KIT-INS
Qty.2



310 x 1984
MOD-FRM-310x1984
Qty.2



992 x 2418
MOD-FRM-992x2418
Qty.3



Counter Shelves
MOD-PNL
Qty.2

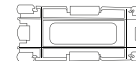

Clip Connector
MOD-CC
Qty.18

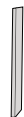

17" Cover Profile
MOD-CP-3100
Qty.2



78" Cover Profile
MOD-CP-3100
Qty.2



95" Cover Profile
MOD-CP-3100
Qty.4

Connections

C

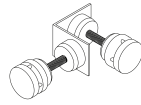

MOD-90D-CON + MOD-PC

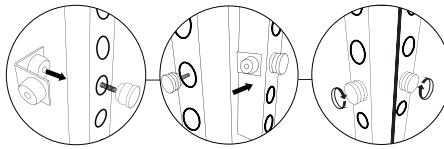

D

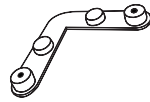

MOD-SM90D-CON / MOD-PC

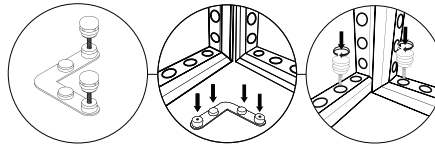

Cover Profiles

E

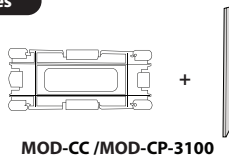

MOD-CC / MOD-CP-3100

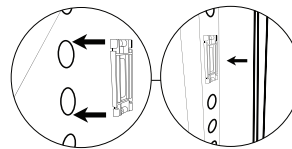

Shelves

F

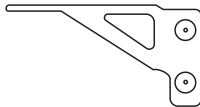

MOD-SHELF-KIT-INS

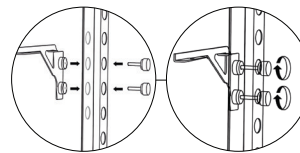

1

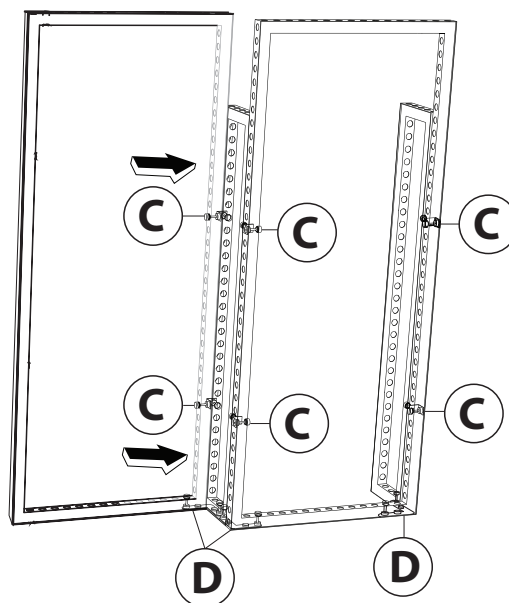

Pre-install graphics on 310x1984 section before connecting.
(Graphic Install page)

2

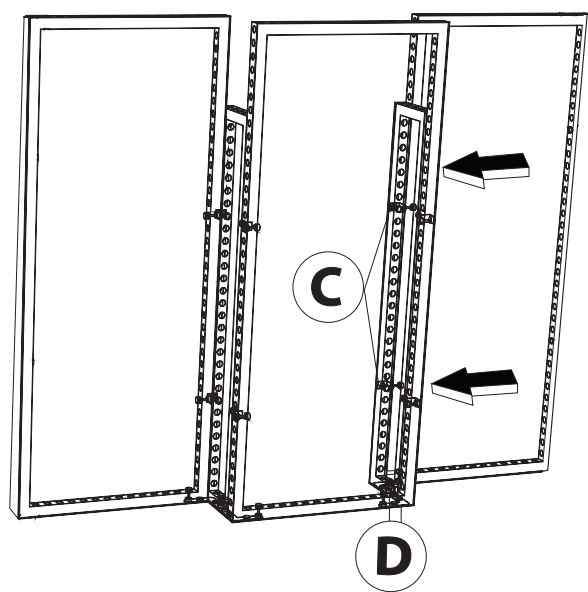

Pre-install graphics on 310x1984 section before connecting.
(Graphic Install page)

3

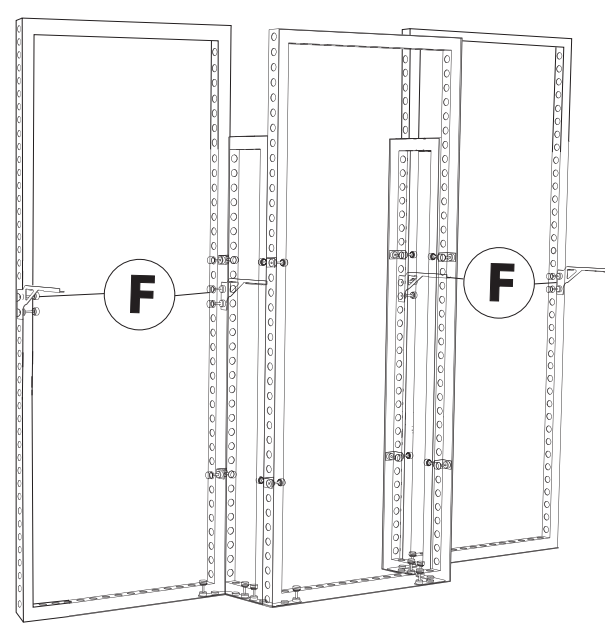

Graphic Install



Place graphic over the front of the frame.



Begin inserting SEG beading at each corner.

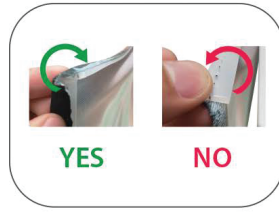

Insert the silicone beading with the fabric folded over. The silicone beading should not be exposed.

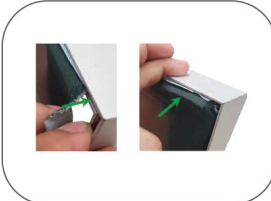

Using your fingers, push both fabric and silicone beading completely into the extrusions channel.

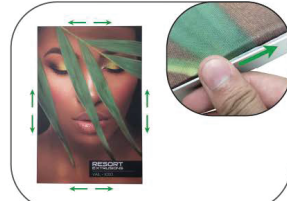

Continue to push in the remaining silicone beading on each side.

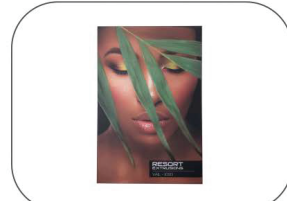

Check the perimeter of the frame for any excess beading that hasn't been pushed in. Graphic should be taut.