

HANGING BANNERS

EXHIBITION & TRADE SHOW
HANGING BANNER 10 FT. SQUARE
42 IN. SINGLE-SIDED

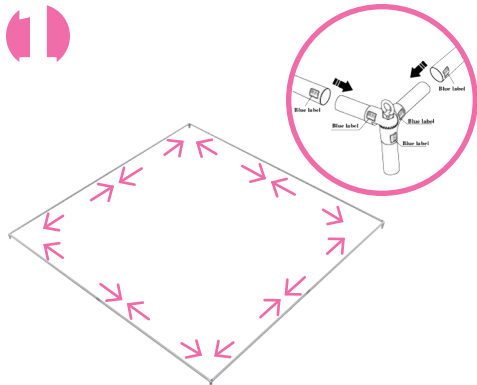

INSTRUCTIONS



- First connect the top straight horizontal tubes (Blue Colored Label: T) and corner connectors. Snap them together.

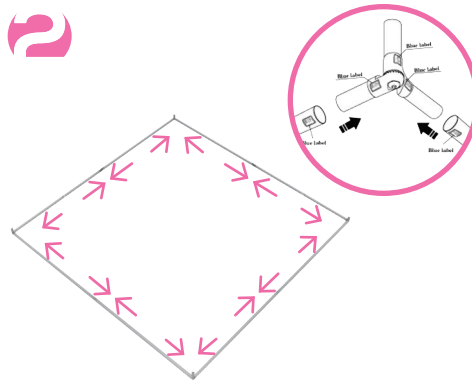

- Connect the bottom straight horizontal tubes (Blue Colored Label: B) and corner connectors. Snap them together.

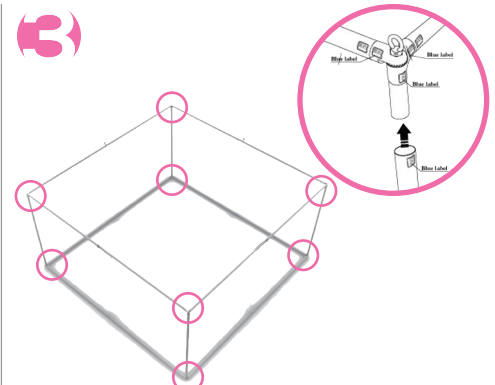

- Then connect the vertical straight tubes (Blue Colored Label: T & B) to the top and bottom corner connectors.

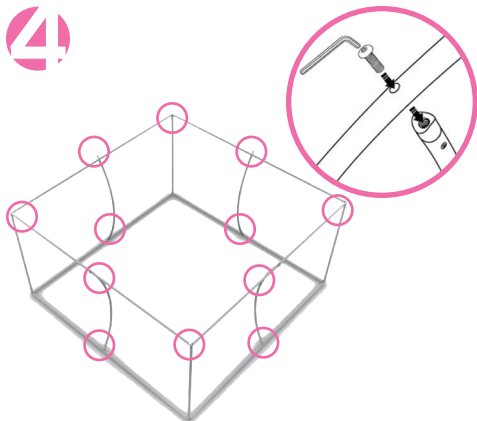

- Locate each screw holes on the sides of the top and bottom tubes. Align the vertical curve tubes within the screw holes at each end. Make sure the middle tubes are bowing inward. Insert large screws into the top and bottom screw holes. Also insert eyehook screws into the top corner connectors. Tighten to secure.

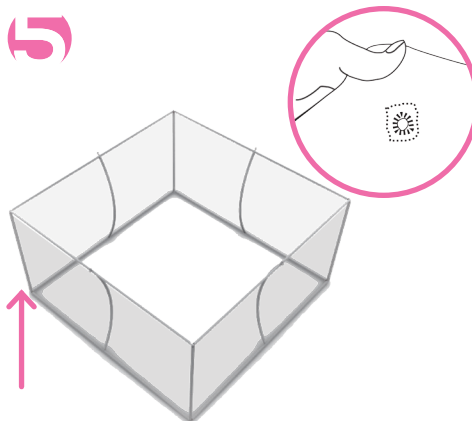

- Place the graphic underneath the frame. Pull up the graphic and cover the entire frame. Make sure the printed graphic faces outwards and the pre-hemmed holes are aligned with the top screws. Insert the eyehooks along the pre-hemmed holes.

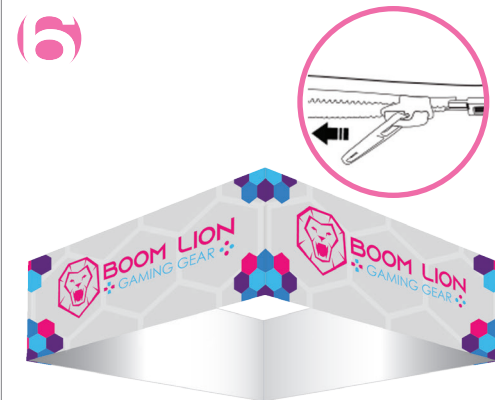

- Using the industrial-size-zipper, zip above the top tube, maximizing fabric tension. And zip to closed.



NOTE: To suspend hanging banner, professional rigging services are recommended and may be required at most sites.

